

THIS SPACE FOR DESIGNER / ENGINEER APPROVAL

Job/Customer _____	Date _____	Contractor _____
Model Specified _____	Qty _____	Approved By _____
Designer/Engineer _____	Date _____	Contractor's PO # _____
Submitted by _____	Date _____	Other _____

Webstone Co. Inc.
 Tel: (800) 225-9529
 Fax: (800) 336-5133
 www.webstonevalves.com



Webstone
 Company, Inc.

The Only Way to Isolate Circulator Pumps

**4040 SERIES
 & 4040HV SERIES
 FULL PORT FORGED BRASS
 BALL VALVE - IPS x FLANGE
 (600 WOG/150 WSP) - ISO 9001
 PATENT PENDING**

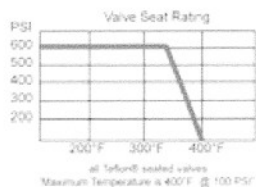

PRESSURE RATING
 600 WOG non-shock
 150 WSP

1. Threaded ends comply with ANSI B1.20.1
2. Solder end complies with ANSI B16.18
3. Manufactured in an ISO 9001 Facility



1.	FLANGED BODY	BRASS (ASTM B283-C37700)
2.	END CAP	BRASS (ASTM B283-C37700)
3.	SEATS	TEFLON® (PTFE)
4.	BALL	BRASS/HARD CHROME PLATE
5.	STEM	BRASS (ASTM B124-C37700)
6.	STEM SEAL	TEFLON® (PTFE)
7.	PACKING GLAND	BRASS (ASTM B124-C37700)
8.	LEVER HANDLE	C.P. STEEL/VINYL GRIPS
8a.	WING STYLE "T" HANDLE	C.P. STEEL
9.	HANDLE NUT	BRASS (ASTM B124-37700)
10.	HANDLE JACKET	VINYL GRIP
11.	MOUNTING BOLTS AND NUTS	STEEL

**FLANGE FOR REGULAR MODELS
 FG H I**

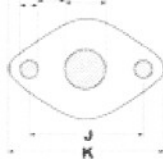

**FLANGE FOR HIGH VELOCITY PUMP MODELS
 excluding the 2" model
 FG H I**

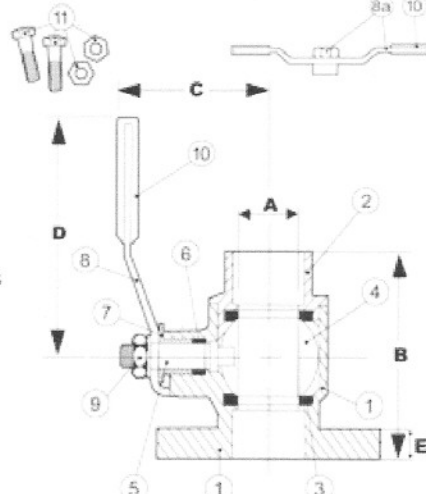
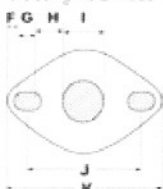

ITEM	SIZE	CTN./CS	A	B	C	D	E	F	G	H	I	J	K	Cv
40402	1/2	2/20	9/16	2	1 7/8	3 1/2	3/8	3/16	1/2	7/8	1 3/16	3 3/16	4 1/8	11.47
40403	3/4	2/20	3/4	2 1/4	2 1/4	4	3/8	3/16	1/2	3/4	1 1/8	3 3/16	4 1/8	24.01
40404	1	2/20	15/16	2 1/2	2 1/2	4 5/8	3/8	3/16	1/2	5/8	1 5/8	3 3/16	4 1/8	49.30
40405	1 1/4	2/20	1 1/4	2 13/16	2 3/4	4 5/8	3/8	3/16	1/2	1/2	1 5/8	3 3/16	4 1/8	14.03
40406	1 1/2	2/20	1 1/2	3 13/16	3 3/8	5 5/8	3/8	3/16	1/2	5/16	2	3 3/16	4 1/8	161.30
40404HV	1	2/20	15/16	2 1/2	2 1/2	4 5/8	3/8	1/8	11/16	5/8	1 5/16	3 1/2	4 9/16	49.30
40405HV	1 1/4	2/20	1 1/4	2 13/16	2 3/4	4 5/8	3/8	1/8	11/16	1/2	1 5/8	3 1/2	4 9/16	14.03
40406HV	1 1/2	2/20	1 1/2	3 13/16	3 3/8	5 5/8	3/8	1/8	11/16	3/8	2	3 1/2	4 9/16	161.30
40407HV	2	2/10	2	4 1/4	3 5/8	5 9/16	3/8	1/2	1/2	5/8	1 7/8	3 1/2	4 9/16	248.61

Cv = The number of gallons of water per minute that pass through the valve at a 1lb pressure drop

Specifications

Approved pump isolation flanged valves shall be 2-piece design constructed of brass unibody flange and end cap. Seats shall be Teflon® (PTFE). Stems shall be brass with a Teflon® (PTFE) seat secured with a brass packing gland to adjust handle actuation tension and prevent leakage for the life of the valve. Valve shall be rated 600WOG. The valve shall be a Webstone Company, Inc. Isolator® or Isolator® with drain.

Webstone product specifications in U.S. customary units are approximate and are provided for reference only. For precise measurements, please contact Webstone Technical Service. Webstone reserves the right to change or modify product design, construction, specifications or materials without prior notice and without incurring any obligation to make such changes and modifications on Webstone products previously or subsequently sold. Teflon® is a registered trademark of DUPONT. Isolator® is a registered trademark of Webstone Company Inc.