



Submittal Data Information

101-031

Model 008 Cartridge Circulators

Effective: September 1, 2003

Supersedes: July 1, 2001

Job: _____ Engineer: _____ Contractor: _____ Rep: _____

ITEM NO.	MODEL NO.	IMP. DIA.	G.P.M.	HEAD/FT.	H.P.	ELEC. CHAR.

Features

- Standard High Capacity Output-Compact Design
- Quiet, Efficient Operation
- Direct Drive-Low Power Consumption
- Unique Replaceable Cartridge Design-Field Serviceable
- Self Lubricating
- No Mechanical Seal
- Unmatched Reliability-Maintenance Free
- Universal Flange to Flange Dimensions
- Cast Iron or Bronze Construction
- Sweat Connections - Optional

Materials of Construction

Casing (Volute): Cast Iron or Bronze
 Stator Housing: Steel
 Cartridge: Stainless Steel
 Impeller: Non-Metallic
 Shaft: Ceramic
 Bearings: Carbon
 O-Ring & Gaskets: EPDM

Model Nomenclature

F – Cast Iron, Flanged
 BF – Bronze, Flanged
 BC – Bronze, Sweat Connections

Variations:

Z – Zoning Circulator
 J – Bronze Cartridge with Cast Iron Casing

Performance Data

Flow Range: 0 – 14 GPM
 Head Range: 0 – 16 Feet
 Minimum Fluid Temperature: 40°F (4°C)
 Maximum Fluid Temperature: 230°F (110°C)
 Maximum Working Pressure: 125 psi
 Connection Sizes: 3/4", 1", 1-1/4", 1-1/2" Flanged,
 3/4" Sweat



FOR INDOOR USE ONLY

Application

The Taco 008 is designed for a wide range of Residential and Light Commercial higher-head water circulating applications. Typical uses include Hydronic heating, Radiant In-Floor/Panel heating and closed-loop Solar heating systems. The Bronze 008 can be used in higher-head Heat Recovery, Water Source Heat Pump, open-loop Solar heat and Domestic Water Recirculation systems. The unique replaceable cartridge contains all of the moving parts and allows for easy service, instead of replacing the entire circulator. Compact, direct-drive, low power consumption design is ideal for high-efficiency jobs.

Pump Dimensions & Weights

Model	Casing	A		B		C		D		F		G		Ship Wt.	
		in.	mm	in.	mm	in.	mm	in.	mm	in.	mm	in.	mm	lbs.	Kg
008-F6	Cast Iron	6	152	4	102	3-3/16	81	2-15/16	75	4-3/4	121	6-3/8	162	8.0	3.6
008-BF6	Bronze F	6	152	4	102	3-3/16	81	2-15/16	75	4-3/4	121	6-3/8	162	8.0	3.6
008-BC6	Bronze S	5-5/8	143	4-9/16	116	3-3/16	81	2-15/16	75	4-3/4	121	6-3/8	162	8.0	3.6

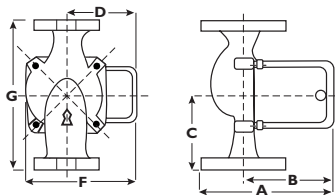

Mounting Positions

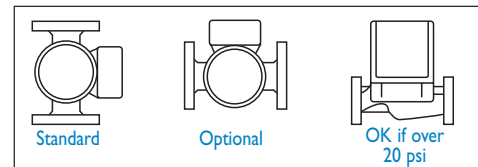

Electrical Data

Model	Volts	Hz	Ph	Amps	RPM	HP
008-F6	115	60	1	.79	3250	1/25
008-BF6	115	60	1	.84	3250	1/25
008-BC6	115	60	1	.84	3250	1/25

Motor Type: Permanent Split Capacitor
 Impedance Protected

Motor Options: 220/50/1, 220/60/1, 230/60/1, 100/110/50/60/1

Flange Orientation

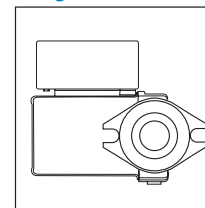

Performance Field - 60Hz

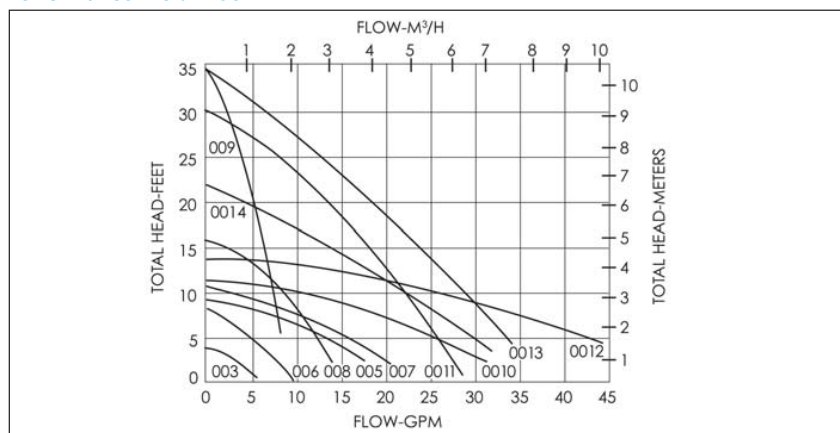

Do it Once. Do it Right.

Taco, Inc., 1160 Cranston Street, Cranston, RI 02920 Telephone: (401) 942-8000 Fax: (401) 942-2360

Taco (Canada), Ltd., 6180 Ordan Drive, Mississauga, Ontario L5T 2B3 Telephone: (905) 564-9422 Fax: (905) 564-9436

Visit our website at: www.taco-hvac.com

Printed in USA
 Copyright 2005
 TACO, Inc.